



ENERGYCRAFT
S Y S T E M S

100 Business Park Circle Suite 203
PO Box 58
Stoughton, WI 53589-0058
(800)350-0776
www.energycraft.com
info@energycraft.com

Down to Earth Energy Saving Solutions™

- Lower Costs
- Increase Profits
- Add Value
- Save Energy

Ideal for all types of buildings!

- Schools
- Offices
- Bus Barns
- Arenas
- Gymnasiums
- Warehouses
- Indoor Skating Rinks
- Manufacturing Plants
- Agricultural Structures
- Churches
- Retail Stores
- Fire Halls
- Repair Shops
- Cold Storage Structures
- Indoor Tennis Facilities
- Aircraft Hangars
- Prison Facilities
- Wine Storage Buildings
- and many more!



Garage Facility



Warehouse Facility

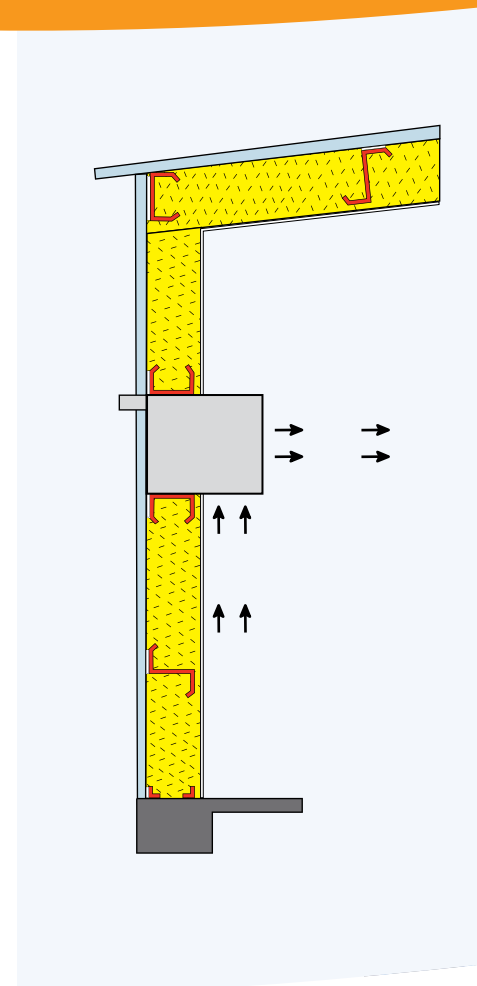

INTEGRATED SYSTEM OF THERMAL INSULATION AND HVAC APPLIANCES

It costs less to have the best!

Not often in life are we given such a clear choice. It usually costs more to do things correctly with high quality products. This is not the case when the high quality Systema Premium System is used. The net cost is typically less due to the significant energy savings which are gained. Most contractors and designers do not properly analyze their designs for energy costs. Their result is typically an obsolete building based upon poor evaluation and predisposed opinions. We at EnergyCraft will analyze and propose the optimum practical design that will result in the lowest net cost to own and operate the building. Typically this results in maximizing the insulation performance first and then sizing all other equipment. Many times it even costs substantially less to own the superior building. So be sure to request the detailed analysis of your proposed building from your EnergyCraft Systems Contractor. It's free! Call today! You will be glad you did.

Call: 1-800-350-0776
E-mail: info@energycraft.com

Green Statement

Because we live on this planet, we have a responsibility to keep it clean. The earth is not ours to abuse; we'll pass it on to our children and generations thereafter. To this end, EnergyCraft Systems promotes renewable energy sources, recyclable materials, and the use of non-pollutants in all of our products wherever possible.

Contact your local EnergyCraft Systems Contractor today for a free consultation!



The Process is the Problem

Frequently, new building proposals are made with insulation R-values perceived to meet the minimum building code requirements. The heating, cooling and ventilation equipment is sized accordingly. Substantial over-sizing of equipment is required to compensate for extra heat transfer due to severely compressed insulation. The equipment then needs wiring circuits, breakers, gas piping, thermostats, exhaust piping, etc. This is typically the base quote. If there is an alternative for more insulation, it is the added cost of compressing even more insulation with little real extra benefit. The costs of these extra insulation alternatives are always higher prices and seldom economically analyzed. So, owners often go with the minimum proposal thinking that it is the best deal for them.

Ironically, this scenario usually assures that the building will actually cost more to own and not less. This is because there is no honest economic analysis of the available designs versus the net cost of ownership. This analysis would include resizing the HVAC equipment, lighting equipment, utilities, etc. Inevitably, superior insulation performance results in the lowest ownership cost for conditioned buildings.



The Superior Alternative

An EnergyCrafted building proposal is superior. If you plan on heating or cooling the interior building space, we automatically propose the insulation system that:

- isolates the conductive steel purlins/girts
- provides thermal breaks between the conductive steel roof panel connections
- yields the full uniform depth of insulation thickness to fill the purlin and girt spaces
- results in the lowest net cost of ownership
- reduces the exposed purlin/girt surface area by 99%

EnergyCraft high efficiency heating and cooling appliances are properly sized for the optimized building. Up to 50% or more reduction in equipment costs and collateral savings is possible. An economic analysis of ownership costs reveals the "EnergyCrafted" building design is the best deal for the owner or user. Ownership costs are less for the superior building. The Systema Insulation System R-values are normally R-30 in the roof and R-25 in the walls. These values are practical to obtain and yield very favorable economics for the building owner and user. This means it costs less!

All Systems Integration is Best

The best design results from analyzing all energy related systems as one. You can't change one without affecting the other. An EnergyCrafted building proposal does exactly this. You get a proposal that will yield the lowest practical ownership cost considering all proposed systems.

- Minimizing heat transfer requires less heating and cooling equipment.
- Maximizing interior surface light reflectivity requires less lighting equipment.
- Maximizing the insulation performance cost is offset by savings of energy using equipment.
- Minimizing energy use lowers energy cost more than increased building payments.

The Systema Premium System integrates the Systema Insulation System and EnergyCraft Heating, Cooling and Ventilation Appliances into one Premium design for superior energy efficiency with the lowest ownership cost. Additional product integration is possible for even more savings with the Systema Premium Plus System. Be sure to call EnergyCraft and request a free proposal and analysis for all of your building projects. Act now and become part of the "In-Solution"... EnergyCraft Systems!

EnergyCraft Appliances for your Temperature Control Needs



We offer a variety of products to fit your building's energy efficiency needs.....



... resulting in the lowest net cost to you!

Systema saves thousands in equipment and energy costs.

- Systema Insulation System
- Long Tab Method
- Over-the-Purlin Method

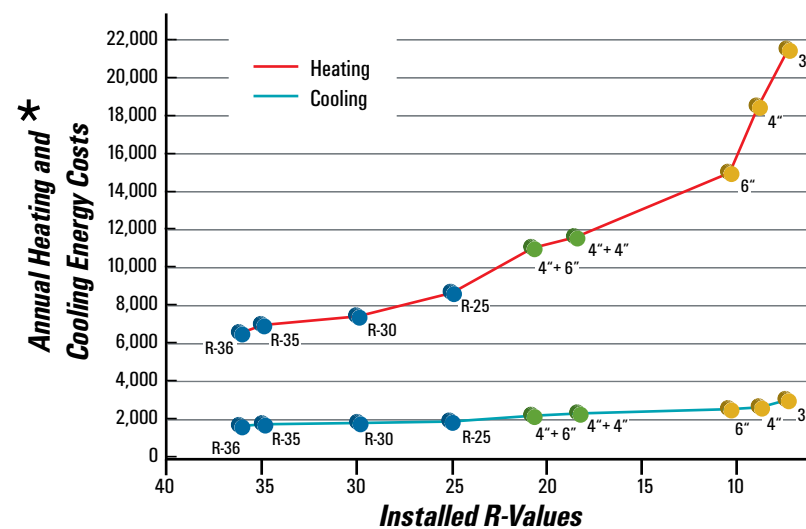
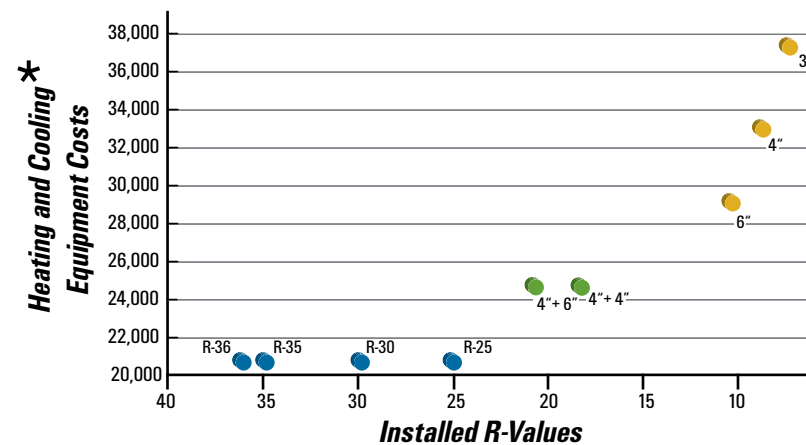
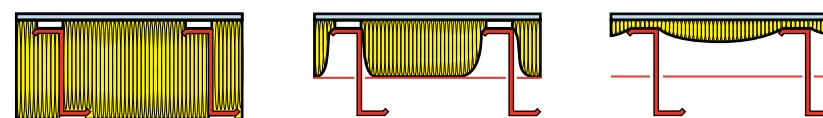

* Examples Based on a 100' x 200' x 20' pre-engineered metal building. Design temperatures: Winter (70° F inside/ -20° F outside) 90° F difference; Summer (75° F inside/ 95° F outside) 20° F difference. Energy costs include dollars spent to heat or cool the building plus the annual maintenance costs. HVAC equipment costs include the cost of the HVAC unit, the HVAC fans, the HVAC electric costs and the electric wiring. All graphs and tables are examples and not guaranteed values.

HVAC Appliances Available:

Type	Horizontal Gas	Horizontal Electric	Horizontal Gas/Electric	Vertical Gas	Vertical Electric	Vertical Gas/Electric
Heating and Cooling		X	X		X	X
Heating Only	X	X		X	X	
Cooling Only		X			X	

We also provide air circulation products including ceiling and horizontal fans.



Retail Facility

Systema Systems add value to your building!

Insulation Type	Energy Saved per Month Compared to 3" Over the Purlin Method	Added Value From Energy Savings That Could Be Amortized Over 20 Years at 7%
R-36 Systema	\$1260	\$162,517.74
R-35 Systema	\$1250	\$161,227.91
R-30 Systema	\$1230	\$158,648.50
R-25 Systema	\$1160	\$149,619.50



Machine Shop

Call today for a proposal and analysis for your building!