

**ENERGYCRAFT**  
S Y S T E M S

100 Business Park Circle Suite 203  
PO Box 58  
Stoughton, WI 53589-0058  
(800)350-0776  
www.energycraft.com  
info@energycraft.com

*Down to Earth Energy Saving Solutions™*

- Lower Costs
- Increase Profits
- Add Value
- Save Energy

**Ideal for all types of buildings!**

- Schools
- Offices
- Bus Barns
- Arenas
- Gymnasiums
- Warehouses
- Indoor Skating Rinks
- Manufacturing Plants
- Agricultural Structures
- Churches
- Retail Stores
- Fire Halls
- Repair Shops
- Cold Storage Structures
- Indoor Tennis Facilities
- Aircraft Hangars
- Prison Facilities
- Wine Storage Buildings
- and many more!



Machine Shop

**EnergyCraft Installation = Profit for you!**

EnergyCraft Systems' products are professionally installed after the building is enclosed. This allows erectors to put up more buildings without stopping to install the insulation in the middle of the erection process. Professional installation from the inside eliminates weather variables, resulting in better quality workmanship and faster completion. These independent installation services eliminate resistance from erectors that don't like insulation systems. Consistent results improve appearance, maximize performance, and add value to buildings. This service provides the opportunity for the industry to change to more energy efficient technologies!



Indoor Sports Facility

**Green Statement**

Because we live on this planet, we have a responsibility to keep it clean. The earth is not ours to abuse; we'll pass it on to our children and generations thereafter. To this end, EnergyCraft Systems promotes renewable energy sources, recyclable materials, and the use of non-pollutants in all of our products wherever possible.

Contact your local EnergyCraft Systems Contractor today for a free consultation! 😊

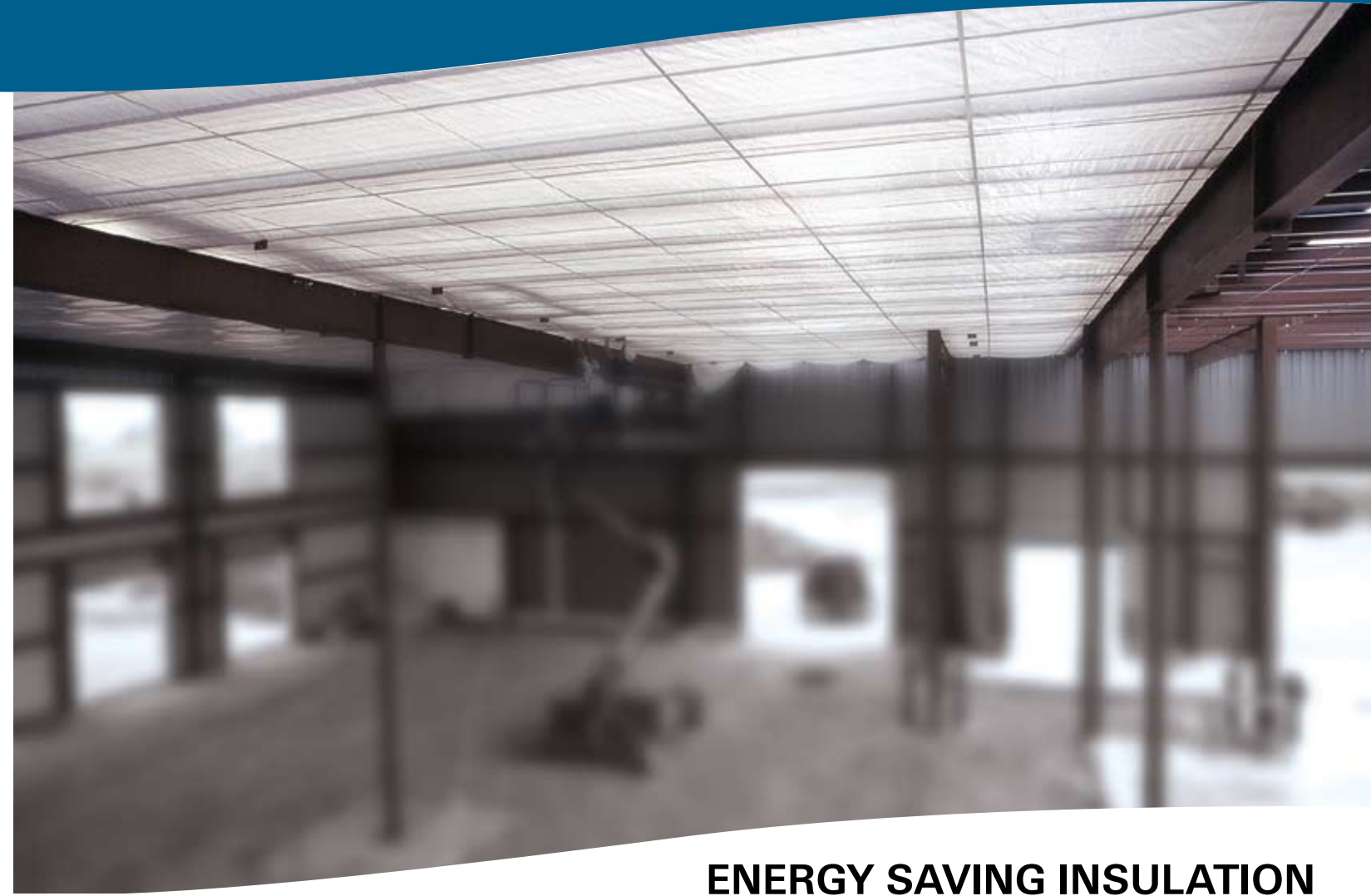

**ENERGY SAVING INSULATION FOR NEW BUILDINGS**

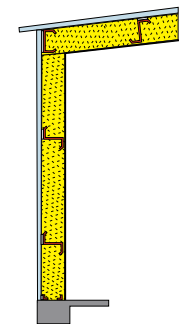
**NEW CONSTRUCTION**

**Superior Insulation Performance**

Energy efficiency begins with optimal insulation. Older metal building insulation methods commonly used are often misrepresented by their package label R-values. Actual installed R-values are substantially less due to compression of the insulation. Our Systema Insulation System creates a uniform depth space for full thickness and full performance of the insulation. The difference is up to 50% reduction in heating and cooling energy consumption forever. Our improved insulation system significantly offsets the costs of HVAC, lighting, electrical and finishing systems.

**Commitment to Excellence**

Your professional EnergyCraft Systems Contractor provides the solutions to resistance to change in the industry. Owners receive superior buildings that cost less to own and operate. Proper vapor barrier placement prevents condensation and corrosion on steel structurals resulting in much longer building life. Lower costs of ownership result in a significant increase in building value compared to the typical metal building system.



**Energy Savings**

Superior technology and professional installation result in collateral savings of HVAC equipment, lighting equipment and finishing costs. Savings also ripple back through electrical and mechanical support systems. Building value is significantly increased. A more attractive and comfortable interior increases productivity and results in additional value.

The net savings value of EnergyCrafted buildings over time will exceed the entire cost of the basic building. Economic analysis supports optimal insulation values which have no perpetual utility cost.

**The highest insulation values produce the lowest ownership cost.**

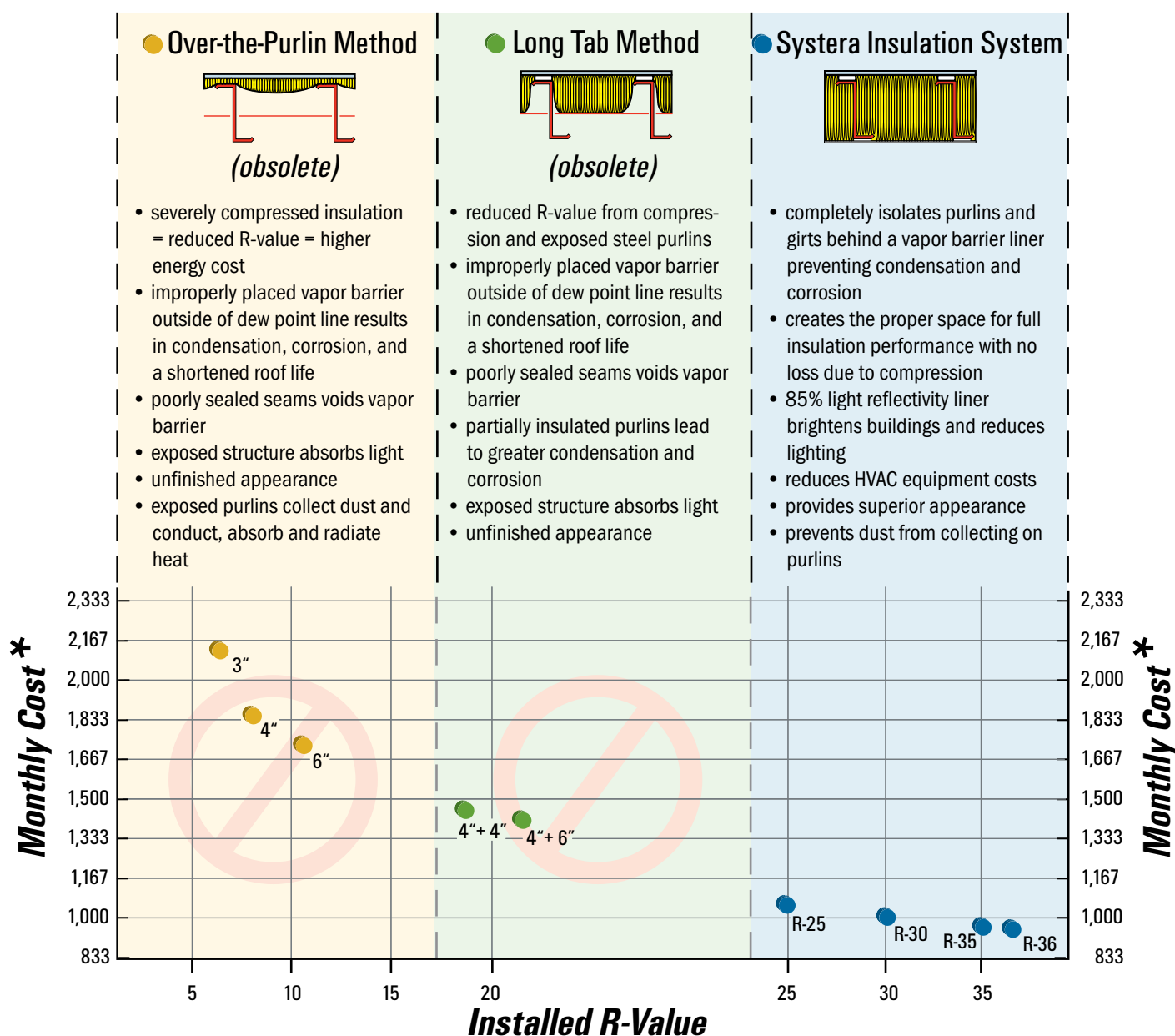

\* Based on a 100' x 200' x 20' pre-engineered metal building; heating and cooling values. Design temperatures: Winter (70° F inside/ -20° F outside) 90° F difference; Summer (75° F inside/ 95° F outside) 20° F difference. Costs include energy and maintenance costs. All graphs and tables are examples and not guaranteed values. Call for a free analysis of your proposed or existing building. 1-800-350-0776

**..... provides free energy analysis.**



Your EnergyCraft Contractor will provide a free computerized analysis of savings that can result from the installation of the Systema Insulation System and the efficient EnergyCraft Heating Appliances or EnergyCraft Heating/Cooling Appliances. They work with your building contractor to provide the ultimate in energy efficient designs and to maximize the collateral savings in other systems.

**..... provides free quotes on maximizing energy efficiency for your building.**



Your EnergyCraft Contractor will assess the needs of your building and give you a guaranteed price quote that gives you optimized performance. It will include pricing for the Systema Insulation System for your new building. EnergyCraft HVAC Appliances and other products and services you desire for your building may also be quoted.

**..... professionally installs the Systema and EnergyCraft products.**



Quality, performance and customer satisfaction are functions of good workmanship. Your EnergyCraft Contractor is specially trained to provide professional installation with consistent quality results. Installation is done from the interior, out of the weather, after the erector has applied the wall and roof sheeting.

**..... offers service and maintenance for your EnergyCrafted building.**



A little tender loving care is always required to keep your systems in top running condition. Your EnergyCraft Contractor can inspect your systems periodically and assure that you are receiving the maximum energy saving benefits you deserve. This service protects your investment and will give you peace of mind.

**Typical Metal Panel Roof and Wall System**

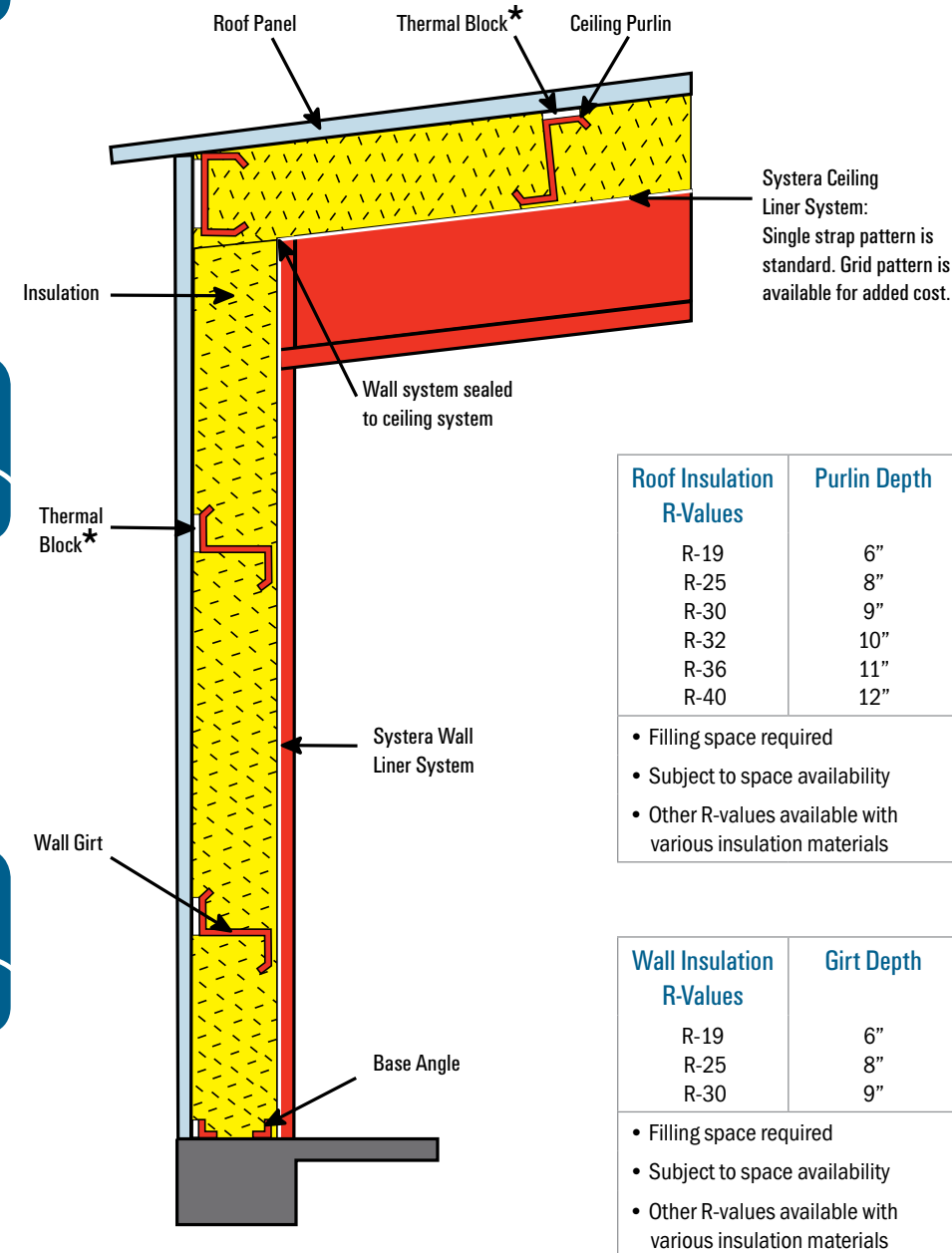

**Available Options of Thermal Blocks**

| Size         | Material                  | Snap-R™ Thermal Block             |
|--------------|---------------------------|-----------------------------------|
| A. 1/8" x 3" | Quik-Stop™ Polyfoam Tape  |                                   |
| B. 3/8" x 3" | Quik-Stop™ Polyfoam Tape  |                                   |
| C. 3/4" x 3" | Quik-Stop™ Polyfoam Block |                                   |
| D. 3/8" x 4" | Snap-R™ Thermal Block     |                                   |
| E. 1" x 4"   | Snap-R™ Thermal Block     |                                   |
| F. 1/2"      | Air space                 |                                   |
|              |                           | Quik-Stop™ Polyfoam Block or Tape |

\* Thermal blocks are optional in buildings with existing insulation. Thermal blocks are required in buildings without existing insulation.